

# Insulation plug IPL

## Advantages

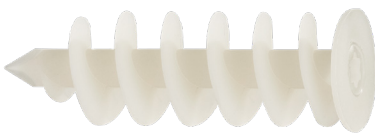

IPL 60



IPL 90

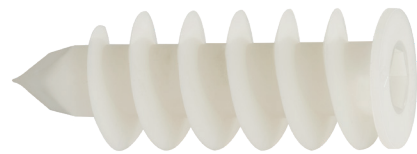

IPL 95

- Special plug for light duty fixings in external insulation composite systems, like letterboxes, lamps, etc.
- Direct fastening into the insulation material - no thermal bridge
- No predrilling necessary due to sharp drill tip; also drills reliably through hard ETICS plaster ( $\leq 7$  mm)
- Nylon plug ageing and weather resistant
- Duo-Bit: One bit for plug (IPL 60 and IPL 90) and screw; saves installation time and money because no bit change is necessary. PZ2/TX40, TX20/TX40 and TX25/TX40 available

## Suitable building materials

### Very suitable

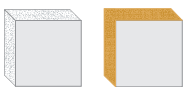

- External Thermal Insulation Composite Systems (ETICS)
- Polystyrene boards
- Hard foam boards
- Heraklith boards
- Wood fibre insulation boards (pre-drilling: 8 mm for IPL60 / IPL90, 13 mm for IPL95, HSS-drill or wood drill recommended)



## Approvals and certificates



## Mounting

### Mounting IPL 60 and IPL 90

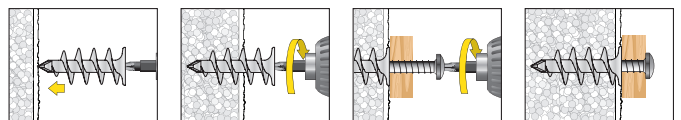

### Mounting IPL 95

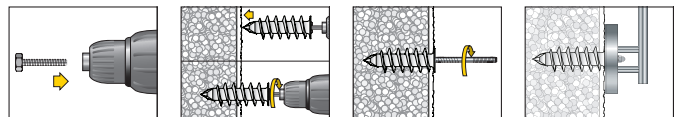

**Recommendation:** Seal plug collar after setting with silicone/acryl to prevent the entry of water into the insulation material.  
Use **CELO StickFX CL p. 203**

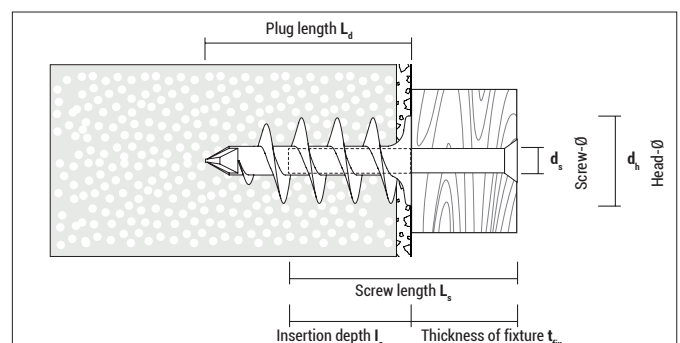

## Insulation plug IPL



## IPL

Type	Art-No	L <sub>d</sub> [mm]	I <sub>s</sub> [mm]	Recess	d <sub>s</sub> [mm]	d <sub>h</sub> [mm]	L <sub>s</sub> [mm]	€ / 100 pcs	[pcs]	[pcs]
IPL 60	960IPL	58	30 - 50	TX 40	4,5 - 5,0	25	30 + t <sub>fix</sub>		25	300
IPL 90	990IPL	87	30 - 50	TX 40	4,5 - 5,0	25	30 + t <sub>fix</sub>		25	200
IPL 95	995IPL	95	40 - 80	SW 13	8 / 10 / M8	32	40 + t <sub>fix</sub>		25	200

IPL 95 incl. 1x screw M8 x 30 as setting tool



## Blister IPL



Type	Art-No	L <sub>d</sub> [mm]	I <sub>s</sub> [mm]	Recess	d <sub>s</sub> [mm]	d <sub>h</sub> [mm]	L <sub>s</sub> [mm]	€ / Blister	[pcs]	[Blister]
IPL 60	560IPL4	58	30 - 50	TX 40	4,5 - 5,0	25	30 + t <sub>fix</sub>		4	10
IPL 95	595IPL2	95	40 - 80	SW 13	8 / 10 / M8	32	40 + t <sub>fix</sub>		2	10

IPL 95 incl. 1x screw M8 x 30 as setting tool



## Blister IPL incl. screw PZ2



Type	Art-No	L <sub>d</sub> [mm]	I <sub>s</sub> [mm]	Recess	d <sub>s</sub> x L <sub>s</sub> [mm]	d <sub>h</sub> [mm]	t <sub>fix</sub> [mm]	Type of screw	€ / Blister	[pcs]	[Blister]
IPL 60	560IPLPZ4	58	30 - 50	TX 40	4,5 x 40	25	≤ 10			4	10

Duo-Bit TX20/TX40, TX25/TX40
 Duo-Bit PZ2/TX40

## Duo-Bit for IPL 60 &amp; IPL 90

Type	Art-No	Dimensions	For use with	€ / pc	€ / Blister	[pcs]	[Blister]
TX20/TX40	7DTX20TX40	1/4" x 43 mm	IPL60 / IPL90 and TX20 screw			2	10
TX25/TX40	7DTX25TX40	1/4" x 43 mm	IPL60 / IPL90 and TX25 screw			2	10
PZ2/TX40	7DPZ2TX40	1/4" x 43 mm	IPL60 / IPL90 and PZ2 screw			2	10

2 pcs packed in a robust plastic box with EURO-punching

## Loads and dimensions

Type	Applications in Polystyrene EPS PS15		Applications in Polystyrene EPS PS20		Applications in Polystyrene XPS	Application in Rockwool, Coverrock Plus	For use with	Screw insertion depth	
	unplastered F <sub>rec</sub> [kN]	plastered F <sub>rec</sub> [kN]	unplastered F <sub>rec</sub> [kN]	plastered F <sub>rec</sub> [kN]	unplastered (30 kg/m³) F <sub>rec</sub> [kN]	unplastered and plastered F <sub>rec</sub> [kN]		min. [mm]	max. [mm]
IPL 60	0,04	0,04*	0,07	0,08*	0,14	0,04 <sup>1)</sup>	Chipboard screws Ø 4,5 - 5,0	30	50 <sup>2)</sup>
IPL 90	0,09	0,09*	0,11	0,13*	0,23	0,05 <sup>1)</sup>	Chipboard screws Ø 4,5 - 5,0	30	50 <sup>3)</sup>
IPL 95	0,09	0,10*	0,13	0,14*	0,28	0,05 <sup>1)</sup>	Hanger bolts Ø8, Ø10 and M8 Screws	40	80

F<sub>rec</sub>: Recommended load in all directions incl. safety factor of 5

\* Value may differ depending on the type and thickness of the plaster

<sup>1)</sup> Avoid impact loads<sup>2)</sup> To prevent the IPL 60 from spinning in the Rockwool insulation material: Screw Ø 5.0 mm → max. screw insertion depth: 35 mm<sup>3)</sup> To prevent the IPL 90 from twisting in the insulation material:

EPS (PS15): screw Ø 5.0 mm → max. screw-in depth: 45 mm

Rockwool: screw Ø 4.5 mm → max. screw-in depth: 45 mm, screw Ø 5.0 mm → not recommended